

High Density Perimeter Block, Towers

2B

Based on: Symphony Park in Las Vegas, NV US

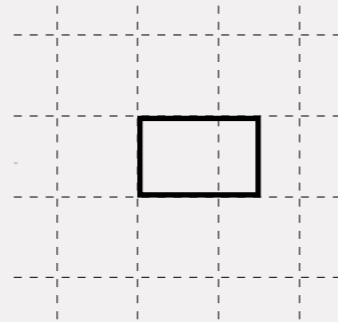
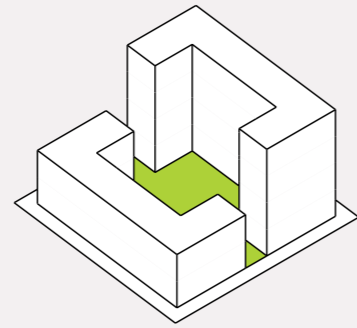

CLUSTER AREA
48600 sq. m

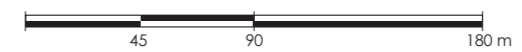
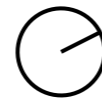

KEY

- green
- roads
- shared roads
- commercial
- pedestrian
- residential
- parking
- public transit
- water
- civic

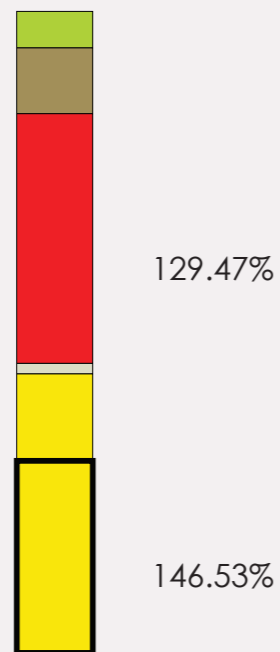

FAR 2.40
LAND COVERAGE 35.7%
UNITS/HECTARE 72

Southern Sun Exposure

0°-13°	0%
13°-90°	53%
0°-90°	53%

